



YLI ELECTRONIC



Infrared Sensor Exit Button

Model: ISK-841A/B/C/D(LED)

Specification

- Size: 90Lx35Wx37.7H(mm) (ISK-841A(LED))
86Lx50Wx37.7H(mm) (ISK-841B(LED))
86Lx86Wx25.7H(mm) (ISK-841C(LED))
114Lx70Wx25.7H(mm) (ISK-841D(LED))
- Input : DC12V
- Contact rating: 1A@30VDC
- Output contact: NO\NC\COM
- Mechanical life: 1,000,000 tests
- Suitable for door: Hollow Door
- Detection range: 4-12cm(Adjustable)
- Time delay: 1~25s(Adjustable)
- Operating temp: -20℃~+50℃(14-131F)
- Suitable humidity: 0-95% (relative humidity)
- LED Indicator:
 - Red LED indicator: Power ON(standby)
 - Green LED indicator: Power ON(sensation)
- Material: Stainless
- Weight: 0.18kg/0.18kg/0.2kg/0.2kg

Installation & Size

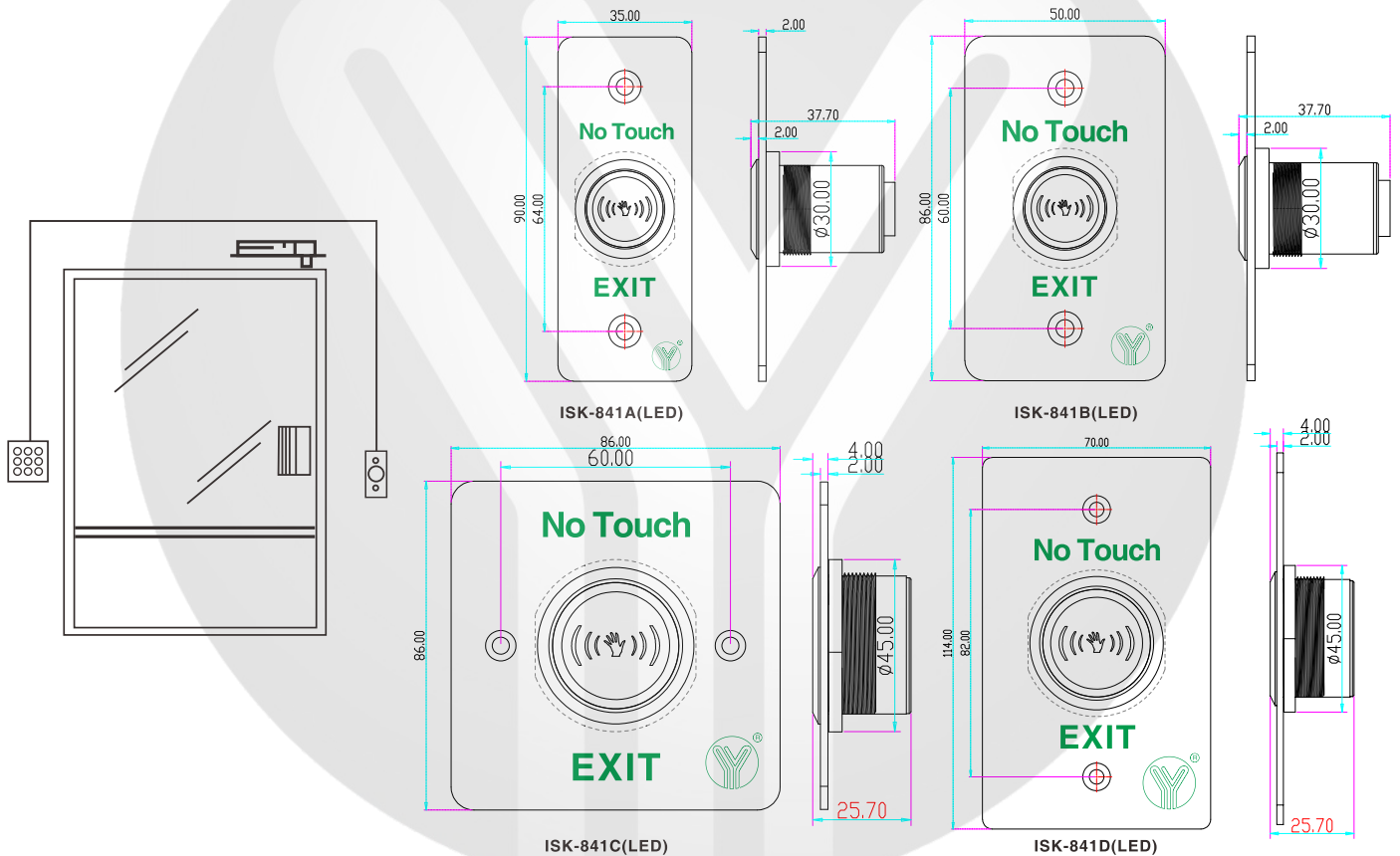

Wiring Diagram

Detection range: 4-12cm(Adjustable)

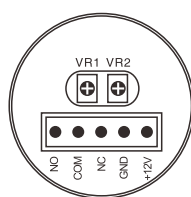
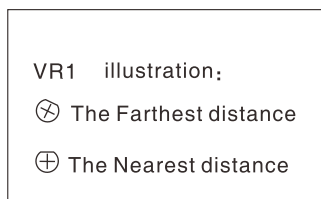

ISK-841A/B(LED)

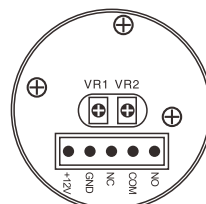

ISK-841C/D(LED)

Time delay: 1S~25S

